

Technical data

Description:	Main Line Branch Terminal 35 mm ² – 1 pole (Al/Cu)
Construction:	Model C – all-side fingersafe, modular system
Item no. :	080210-x-3

Remarks: The product is compliant with the EC ROHS directives

Standards: IEC 60947-7-1, IEC 61238-1, UL-1059 / CSA C22.2 No.158-10, DIN VDE 0603-3-1



Nominal Voltage: 1.000 V AC / 1.000 V DC

Nominal current: Cu 202 A (2x25mm²); 125 A (1x35mm²) as per IEC 60947-7-1
Al 125 A (1x35mm²)* as per IEC 61238-1 (Class A)

* Approved with Reko SFS 4880 (manufactured by Reka Cables Ltd)

Power loss: Tested by SGS Fimko Ltd (FI) (see chart 1)

Terminal cross section:

	2 x 35 mm ² (round conductor)			2 x 25 mm ² (round conductor)		
	Cu	Al		Cu	Al	
35 mm ²			-			-
25 mm ²	3,5 Nm	3,5 Nm	8 Nm	2,5 Nm	2,5 Nm	6 Nm
16 mm ²			6 Nm			4 Nm
10 mm ²			4 Nm			-
6 mm ²			-			-
4 mm ²	-	-	-	-	-	-
2,5 mm ²	-	-	-	-	-	-
1,5 mm ²	-	-	-	-	-	-
stripping length	22 mm			18 mm		
screw	M8 (+/- PZ2)			M6 (+/- PZ2)		

Materials: Terminal body: brass (CuZn39Pb2) 3-4µm Ni / 7-10µm Sn
Housing: PA 6 (Halogen-free)
Screws: steel Zn thick-film passivated

Flame resistance: Self-extinguishing

Mechanical data: Dimensions: width x height x depth (mm): 29 x 49,3 x 55,4

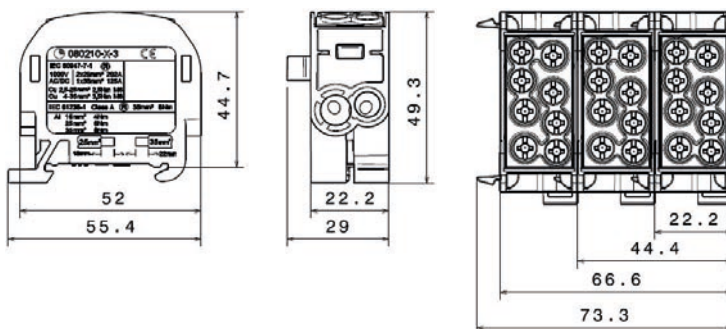
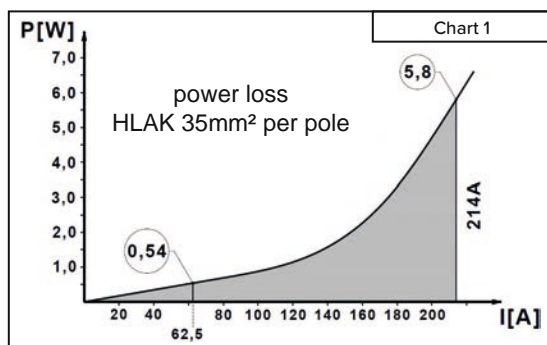

Design

Basic housing colour – light grey RAL 7035

Part no.	Design	Cover colour	PU	GTIN (EAN)
080210-0-3	L "G"	light grey RAL 7035	5	4051589021036
080210-1-3	N	light blue RAL 5012	5	4051589021135
080210-2-3	PE	yellow-green RAL 6018	5	4051589021234
080210-3-3	L "B"	clay brown RAL 8003	5	4051589021333
080210-4-3	L "S"	jet black RAL 9005	5	4051589021432

Technical data

Description:	Main Line Branch Terminal 35 mm ² – 1 pole (Cu)
Construction:	Model C – all-side fingersafe, modular system
Item no. :	080210-x-4

Remarks: The product is compliant with the EC ROHS directives

Standards: IEC 60947-7-1, DIN VDE 0603-3-1



Nominal Voltage: 1.000 V AC / 1.000 V DC

Nominal current: Cu 202 A (2x25mm²); 125 A (1x35mm²) as per IEC 60947-7-1

Power loss: Tested by SGS Fimko Ltd (FI) (see chart 1)

Terminal cross section:	2 x 35 mm ² (round conductor)		2 x 25 mm ² (round conductor)	
	Cu		Cu	
35 mm ²				
25 mm ²	3,5 Nm	3,5 Nm	-	-
16 mm ²				
10 mm ²				
6 mm ²			2,5 Nm	2,5 Nm
4 mm ²				
2,5 mm ²	-	-	-	-
1,5 mm ²	-	-	-	-
stripping length	22 mm		18 mm	
screw	M8 (+/- PZ2)		M6 (+/- PZ2)	

Materials: Terminal body: brass (CuZn39Pb2) bright
Housing: PA 6 (Halogen-free)
Screws: steel Zn thick-film passivated

Flame resistance: Self-extinguishing

Mechanical data: Dimensions: width x height x depth (mm): 29 x 49,3 x 55,4

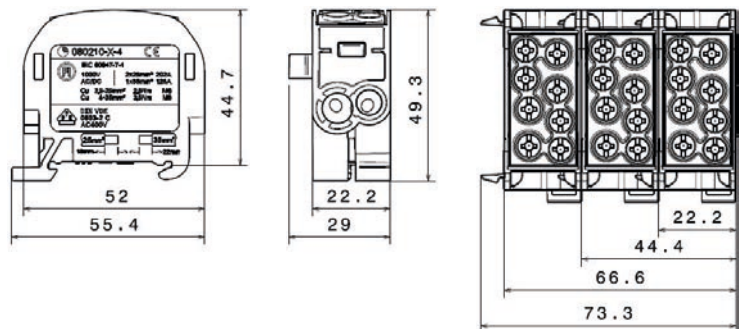
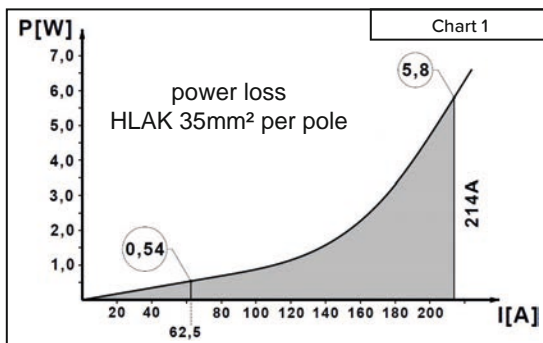

Design

Basic housing colour – light grey RAL 7035

Part no.	Design	Cover colour	PU	GTIN (EAN)
080210-0-4	L "G"	light grey RAL 7035	5	4051589802109
080210-1-4	N	light blue RAL 5012	5	4051589802116
080210-2-4	PE	yellow-green RAL 6018	5	4051589802123
080210-3-4	L "B"	clay brown RAL 8003	5	4051589802130
080210-4-4	L "S"	jet black RAL 9005	5	4051589802147

Technical data

Description:	Main Line Branch Terminal 35 mm ² „double block“ – 1 pole (Al/Cu)
Construction:	Model C – all-side fingersafe, modular system
Item no. :	080220-x-3

Remarks: The product is compliant with the EC ROHS directives

Standards: IEC 60947-7-1, IEC 61238-1, DIN VDE 0603-3-1



Nominal Voltage: 1.000 V AC / 1.000 V DC

Nominal current: Cu 428 A (4x25mm²); 125 A (1x35mm²) as per IEC 60947-7-1

Al 125 A (1x35mm²)* as per IEC 61238-1 (Class A)

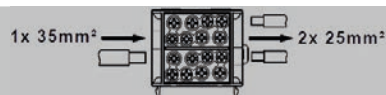

* Approved with Reko SFS 4880 (manufactured by Reka Cables Ltd)

Power loss: Tested by SGS Fimko Ltd (FI) (see chart 1)

Terminal cross section:

	4 x 35 mm ² (round conductor)			4 x 25 mm ² (round conductor)		
	Cu		Al	Cu		Al
	35 mm ²					
25 mm ²	-	-	8 Nm	-	-	-
16 mm ²	3,5 Nm	3,5 Nm	6 Nm	2,5 Nm	2,5 Nm	6 Nm
10 mm ²			4 Nm			4 Nm
6 mm ²			-			-
4 mm ²	-	-	-	-	-	-
2,5 mm ²	-	-	-	-	-	-
1,5 mm ²	-	-	-	-	-	-
stripping length	22 mm			18 mm		
screw	M8 (+/- PZ2)			M6 (+/- PZ2)		

Materials: Terminal body: brass (CuZn39Pb2) 3-4µm Ni / 7-10µm Sn
Housing: PA 6 (Halogen-free)
Screws: steel Zn thick-film passivated

Flame resistance: Self-extinguishing

Mechanical data: Dimensions: width x height x depth (mm): 49,9 x 49,3 x 55,4

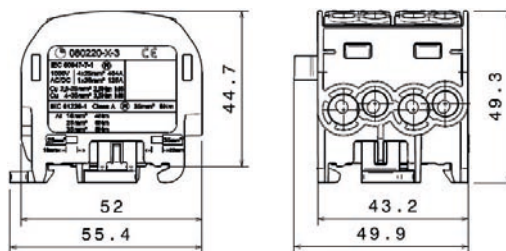
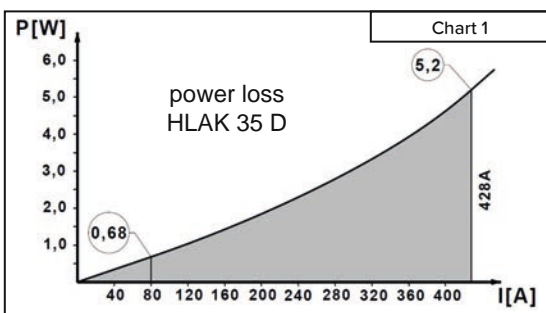

Design

Basic housing colour – light grey RAL 7035

Part no.	Design	Cover colour	PU	GTIN (EAN)
080220-0-3	L "G"	light grey RAL 7035	2	4051589022033
080220-1-3	N	light blue RAL 5012	2	4051589022132
080220-2-3	PE	yellow-green RAL 6018	2	4051589022231
080220-3-3	L "B"	clay brown RAL 8003	2	4051589022330
080220-4-3	L "S"	jet black RAL 9005	2	4051589022439

HORA eTec GmbH

Lange Strasse 65, D - 32257 Bünde, Phone: +49 (0) 52 23 / 49 80 - 0

E-mail: info@hora-etec.com, Internet: www.hora-etec.com

Technical data

Description:	Main Line Branch Terminal 35 mm ² „double block“ – 1 pole (Cu)
Construction:	Model C – all-side fingersafe, modular system
Item no. :	080220-x-4

Remarks: The product is compliant with the EC ROHS directives

Standards: IEC 60947-7-1, DIN VDE 0603-3-1



Nominal Voltage: 1.000 V AC / 1.000 V DC

Nominal current: Cu 428 A (4x25mm²); 125 A (1x35mm²) as per IEC 60947-7-1

Power loss: Tested by SGS Fimko Ltd (FI) (see chart 1)

Terminal cross section:

	4 x 35 mm ² (round conductor)		4 x 25 mm ² (round conductor)	
	Cu		Cu	
35 mm ²	3,5 Nm	3,5 Nm	-	-
25 mm ²				
16 mm ²				
10 mm ²				
6 mm ²				
4 mm ²	2,5 Nm	2,5 Nm	2,5 Nm	2,5 Nm
2,5 mm ²				
1,5 mm ²				
stripping length	22 mm		18 mm	
screw	M8 (+/- PZ2)		M6 (+/- PZ2)	

Materials: Terminal body: brass (CuZn39Pb2) bright
 Housing: PA 6 (Halogen-free)
 Screws: steel Zn thick-film passivated

Flame resistance: Self-extinguishing

Mechanical data: Dimensions: width x height x depth (mm): 49,9 x 49,3 x 55,4

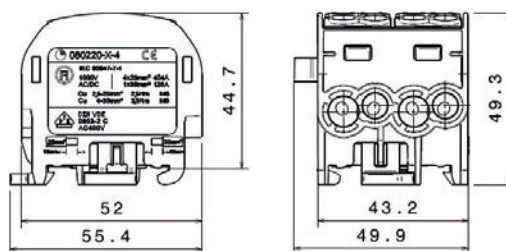
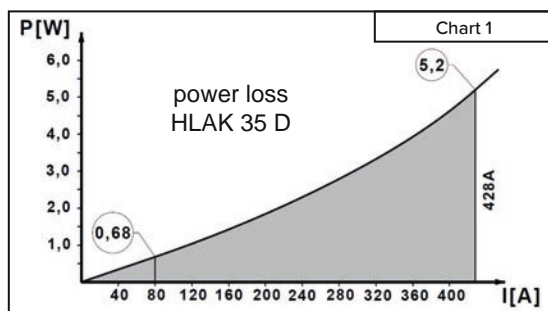

Design

Basic housing colour – light grey RAL 7035

Part no.	Design	Cover colour	PU	GTIN (EAN)
080220-0-4	L "G"	light grey RAL 7035	2	4051589802208
080220-1-4	N	light blue RAL 5012	2	4051589802215
080220-2-4	PE	yellow-green RAL 6018	2	4051589802222
080220-3-4	L "B"	clay brown RAL 8003	2	4051589802239
080220-4-4	L "S"	jet black RAL 9005	2	4051589802246

Technical data

Description:	Main Line Branch Terminal 35 mm ² – 3 pole (Al/Cu)
Construction:	Model C – all-side fingersafe, modular system
Item no. :	080230-x-3

Remarks: The product is compliant with the EC ROHS directives

Standards: IEC 60947-7-1, IEC 61238-1, DIN VDE 0603-3-1



Nominal Voltage: 1.000 V AC / 1.000 V DC

Nominal current: Cu 202 A (2x25mm²); 125 A (1x35mm²) as per IEC 60947-7-1
Al 125 A (1x35mm²)* as per IEC 61238-1 (Class A)

* Approved with Reko SFS 4880 (manufactured by Reka Cables Ltd)

Power loss: Tested by SGS Fimko Ltd (FI) (see chart 1)

Terminal cross section:
(per pole)

	2 x 35 mm ² (round conductor)			2 x 25 mm ² (round conductor)		
	Cu		Al	Cu		Al
35 mm ²						
25 mm ²	3,5 Nm	3,5 Nm	8 Nm	2,5 Nm	2,5 Nm	-
16 mm ²			6 Nm			6 Nm
10 mm ²			4 Nm			4 Nm
6 mm ²			-			-
4 mm ²	-	-	-	-	-	-
2,5 mm ²	-	-	-	-	-	-
1,5 mm ²	-	-	-	-	-	-
stripping length	22 mm			18 mm		
screw	M8 (+/- PZ2)			M6 (+/- PZ2)		

Materials: Terminal body: brass (CuZn39Pb2) 3-4µm Ni / 7-10µm Sn
Housing: PA 6 (Halogen-free)
Screws: steel Zn thick-film passivated

Flame resistance: Self-extinguishing

Mechanical data: Dimensions: width x height x depth (mm): 73,1 x 49,3 x 55,4

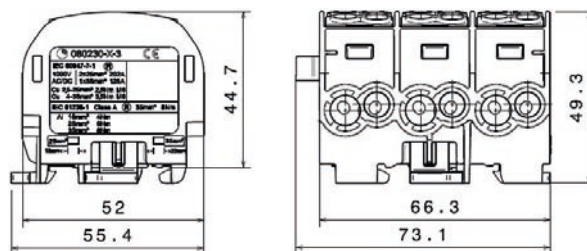
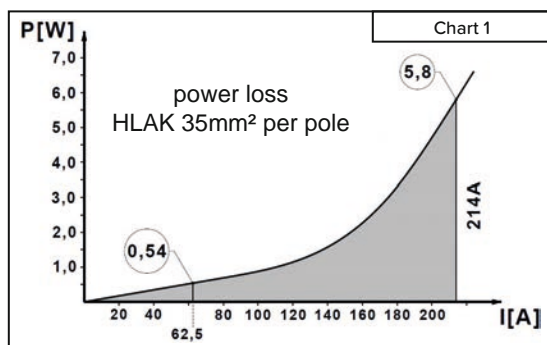

Design

Basic housing colour – light grey RAL 7035

Part no.	Design	Cover colour	PU	GTIN (EAN)
080230-0-3	3L		-	4051589023030
080230-1-3	L / N / PE		-	4051589023139
080230-2-3	PE / L / N		-	4051589023238
080230-3-3	2L / N		-	4051589023337
080230-4-3	2L / PE		-	4051589023436

HORA eTec GmbH

Lange Strasse 65, D - 32257 Bünde, Phone: +49 (0) 52 23 / 49 80 - 0

E-mail: info@hora-etec.com, Internet: www.hora-etec.com

Technical data

Description:	Main Line Branch Terminal 35 mm ² – 3 pole (Cu)
Construction:	Model C – all-side fingersafe, modular system
Item no. :	080230-x-4

Remarks: The product is compliant with the EC ROHS directives

Standards: IEC 60947-7-1, DIN VDE 0603-3-1



Nominal Voltage: 1.000 V AC / 1.000 V DC

Nominal current: Cu 202 A (2x25mm²); 125 A (1x35mm²) as per IEC 60947-7-1

Power loss: Tested by SGS Fimko Ltd (FI) (see chart 1)

Terminal cross section:
(per pole)

	2 x 35 mm ² (round conductor)		2 x 25 mm ² (round conductor)		
	Cu		Cu		
35 mm ²	3,5 Nm	-	2,5 Nm	-	
25 mm ²		-		-	
16 mm ²		3,5 Nm		2,5 Nm	2,5 Nm
10 mm ²					
6 mm ²					
4 mm ²					
2,5 mm ²	-	-	-		
1,5 mm ²	-	-	-		
stripping length	22 mm		18 mm		
screw	M8 (+/- PZ2)		M6 (+/- PZ2)		

Materials:

Terminal body:	brass (CuZn39Pb2)	bright
Housing:	PA 6 (Halogen-free)	
Screws:	steel	Zn thick-film passivated

Flame resistance: Self-extinguishing

Mechanical data: Dimensions: width x height x depth (mm): 73,1 x 49,3 x 55,4

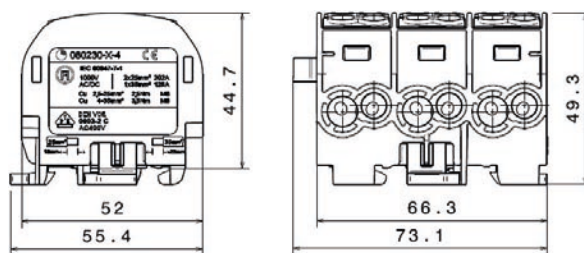
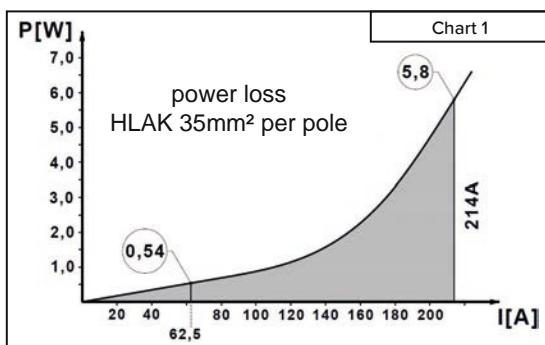

Design

Basic housing colour – light grey RAL 7035

Part no.	Design	Cover colour	PU	GTIN (EAN)
080230-0-4	3L		-	4051589802307
080230-1-4	L / N / PE		-	4051589802314
080230-2-4	PE / L / N		-	4051589802321
080230-3-4	2L / N		-	4051589802338
080230-4-4	2L / PE		-	4051589802345

Technical data

Description:	Main Line Branch Terminal 35 mm ² – 5 pole (Al/Cu)
Construction:	Model C – all-side fingersafe, modular system
Item no. :	080250-x-3

Remarks: The product is compliant with the EC ROHS directives

Standards: IEC 60947-7-1, IEC 61238-1, DIN VDE 0603-3-1



Nominal Voltage: 1.000 V AC / 1.000 V DC

Nominal current: Cu 202 A (2x25mm²); 125 A (1x35mm²) as per IEC 60947-7-1
Al 125 A (1x35mm²)* as per IEC 61238-1 (Class A)

* Approved with Reko SFS 4880 (manufactured by Reka Cables Ltd)

Power loss: Tested by SGS Fimko Ltd (FI) (see chart 1)

Terminal cross section:
(per pole)

	2 x 35 mm ² (round conductor)			2 x 25 mm ² (round conductor)		
	Cu		Al	Cu		Al
	35 mm ²			8 Nm		
25 mm ²	3,5 Nm	3,5 Nm	6 Nm	2,5 Nm	2,5 Nm	6 Nm
16 mm ²			4 Nm			4 Nm
10 mm ²			-			-
6 mm ²			-			-
4 mm ²	-	-	-	-	-	-
2,5 mm ²	-	-	-	-	-	-
1,5 mm ²	-	-	-	-	-	-
stripping length	22 mm			18 mm		
screw	M8 (+/- PZ2)			M6 (+/- PZ2)		

Materials: Terminal body: brass (CuZn39Pb2) 3-4µm Ni / 7-10µm Sn
Housing: PA 6 (Halogen-free)
Screws: steel Zn thick-film passivated

Flame resistance: Self-extinguishing

Mechanical data: Dimensions: width x height x depth (mm): 117,6 x 49,3 x 55,4

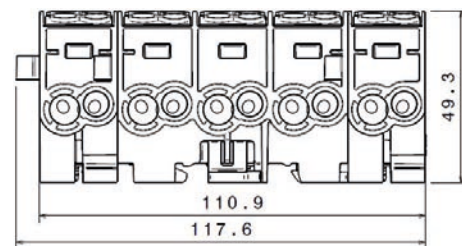
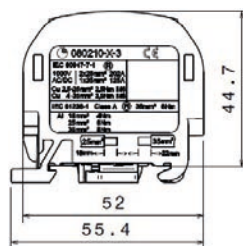
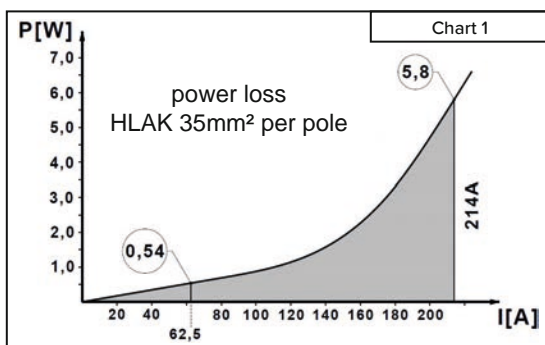

Design

Basic housing colour – light grey RAL 7035

Part no.	Design	Cover colour	PU	GTIN (EAN)
080250-0-3	5L		1	4051589025034
080250-1-3	3L / N / PE		1	4051589025133
080250-2-3	N / 3L / PE		1	4051589025232
080250-3-3	PE / 3L / N		1	4051589025331
080250-4-3	3L / PE / N		1	4051589025430
080250-5-3	PE / 3L "BSG" / N		1	4051589025539

Technical data

Description:	Main Line Branch Terminal 35 mm ² – 5 pole (Cu)
Construction:	Model C – all-side fingersafe, modular system
Item no. :	080250-x-4

Remarks: The product is compliant with the EC ROHS directives

Standards: IEC 60947-7-1, DIN VDE 0603-3-1



Nominal Voltage: 1.000 V AC / 1.000 V DC

Nominal current: Cu 202 A (2x25mm²); 125 A (1x35mm²) as per IEC 60947-7-1

Power loss: Tested by SGS Fimko Ltd (FI) (see chart 1)

Terminal cross section:
(per pole)

	2 x 35 mm ² (round conductor)		2 x 25 mm ² (round conductor)	
	Cu		Cu	
35 mm ²	3,5 Nm	3,5 Nm		2,5 Nm
25 mm ²				
16 mm ²				
10 mm ²				
6 mm ²				
4 mm ²			2,5 Nm	
2,5 mm ²				
1,5 mm ²				
stripping length	22 mm		18 mm	
screw	M8 (+/- PZ2)		M6 (+/- PZ2)	

Materials:

Terminal body:	brass (CuZn39Pb2)	bright
Housing:	PA 6 (Halogen-free)	
Screws:	steel	Zn thick-film passivated

Flame resistance: Self-extinguishing

Mechanical data: Dimensions: width x height x depth (mm): 117,6 x 49,3 x 55,4

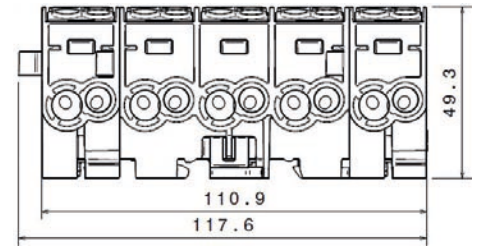
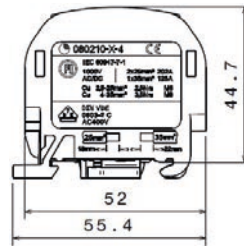
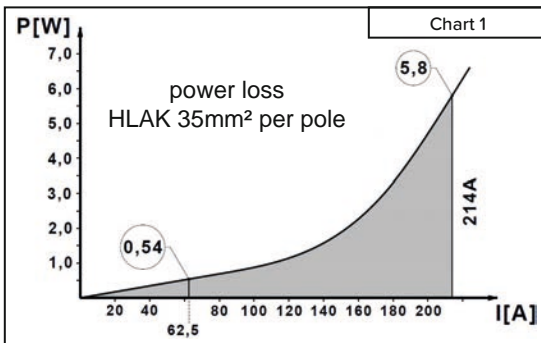

Design

Basic housing colour – light grey RAL 7035

Part no.	Design	Cover colour	PU	GTIN (EAN)
080250-0-4	5L		1	4051589802505
080250-1-4	3L / N / PE		1	4051589802512
080250-2-4	N / 3L / PE		1	4051589802529
080250-3-4	PE / 3L / N		1	4051589802536
080250-4-4	3L / PE / N		1	4051589802543
080250-5-4	PE / 3L "BSG" / N		1	4051589802550